



Accurate external data,
ready for CAD or BIM...

Measured Survey

Design & Construction

Who We Are

Survey Air is a team of MRICS surveyors, licensed UAV pilots and geospatial specialists, offering enterprise drone services.

How It Works



Free Quote & Consultation



Detailed Pre-Flight Planning



Extensive UAV Data Capture



Fast & Efficient Output

What We Offer



UAV Photogrammetry



LiDAR Point Clouds



Multispectral Imaging



Advanced Processing

Contact Us

Any questions? We're here to help...

admin@surveyair.co.uk | www.surveyair.co.uk

Collect highly accurate survey data for urban design, planning, and construction workflows.

At Survey Air, we deliver efficient, cost-effective mapping surveys, tailor-made to facilitate planning and design.

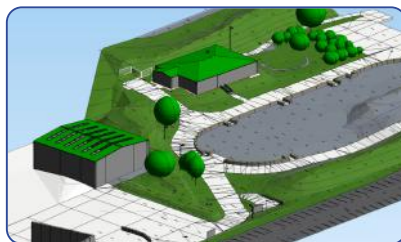

Technical Design

UAV data can generate outputs in DWG & LAS formats, ensuring compatibility with AutoCAD and BIM workflows.

Roof & Elevation Plans

Drones capture hard to access façades, rooflines, and architectural features, supporting terrestrial scans.



Topographical Modelling

Obtain accurate ground levels, boundaries, and site features, including contours, spot height and surface details.

Why choose us? Trusted. Experienced. Reliable.



Custom-built dedicated client portal.



Up to **40-70%** time savings on data collection.



Fully compliant with UK **CAA** regulations.

Measured Survey

Outlined below is the pricing structure for our measured survey services, delivering, geo-referenced outputs suitable for AutoCAD exports, including DWG and Revit formats.

Area Capture	<20k m ²	<100k m ²	<200k m ²	<360k m ²
Photogrammetry	£1,750.00	£2,400.00	£3,600.00	£5,000.00
Price per 10k m ²	£875.00	£240.00	£180.00	£139.00
LiDAR	£1,750.00	£2,400.00	£3,600.00	£5,000.00
Price per 10k m ²	£875.00	£240.00	£180.00	£139.00
On-Site				
Terrestrial LiDAR	£1,150.00	£2,300.00	£3,450.00	£5,000.00
2 nd Flight Crew	£250.00	£250.00	£250.00	£250.00
Basic Processing				
Point Cloud	£1,750.00	£2,400.00	£3,600.00	£5,000.00
CRS Manipulation	£250.00	£250.00	£250.00	£250.00
GCP Triangulation	£250.00	£250.00	£250.00	£250.00
Advanced Processing				
Noise Removal	£110.00	£220.00	£330.00	£440.00
Cloud Thinning	£110.00	£220.00	£330.00	£440.00
LAS Classification	£750.00	£1,500.00	£2,250.00	£3,000.00
Textured 3D Mesh	£110.00	£220.00	£330.00	£440.00
Outputs				
RGB Imagery	£110.00	£220.00	£330.00	£440.00
2D Orthomosaic	£110.00	£220.00	£330.00	£440.00
Digital Elevation Model	£110.00	£220.00	£330.00	£440.00
Digital Surface Model	£110.00	£220.00	£330.00	£440.00
Exports				
DWG	£1,000.00	£1,500.00	£2,000.00	£2,500.00
Revit Model	£450.00	£900.00	£1,350.00	£1,800.00

All prices are quoted exclusive of VAT at 20%. This pricing structure is subject to change based on site conditions, scope of work, and client requirements. A detailed proposal will be provided upon confirmation of project specifics. Should you have any questions or require further information, please contact us at admin@surveyair.co.uk.
© 2025 Survey Air. All rights reserved.